



In-Tank Filters Disposable Filter Cartridge Type

Return Line Application

Model "LFT, LFTA"-750, 1000, 1250

Specifications

- Working pressure 100 PSI (7 bar)
- Operating temperatures -22°F to +212°F (-32°C to +100°C)
- Flows to 40 GPM
- Bypass 25 PSI
- Compatible with mineral oils HH, HL, HM, HR, HV HG according to ISO 6743/4
- Aluminum casting with nylon filter bowl
- Nylon thread on cover

Options

- NPT or SAE ports
- 10, 25 micron cellulose, synthetic elements
- Visual or electrical indicators



LFT-1250



LFTE

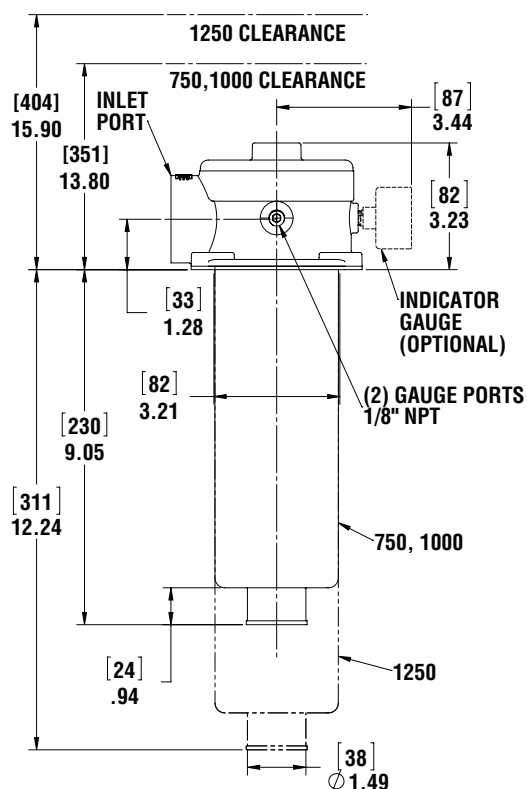
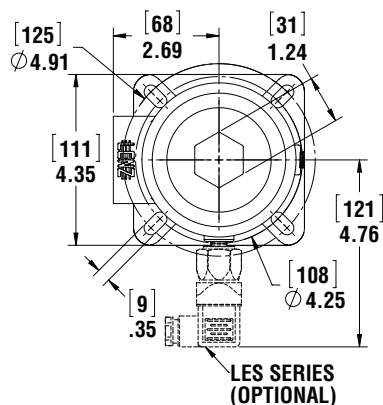

See Technical Bulletin TB.FIL09.708, TB.FIL11.708, TB.FIL20.708, for further information at (Technical Data – www.lenzinc.com)

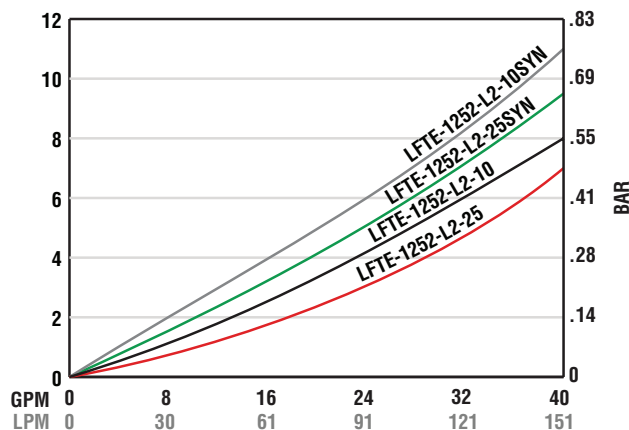
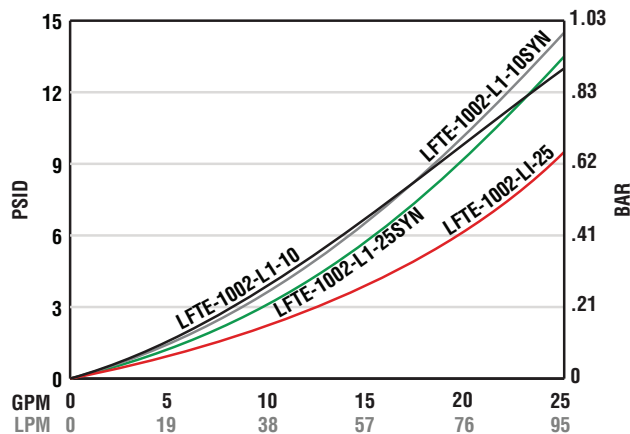

Temperature 100°F Viscosity 150 SUS
Average pressure drop through clean assembly

Assembly Ordering Code

LFT — 750 — 10 — L1 — T

Series		Port Size		Element		Bowl Length		Ind. Ports	
LFT	(NPT)	750	3/4"	10	10 Micron Cellulose	L1	750, 1000	Omit	None
LFTA	(SAE)	1000	1"	25	25 Micron Cellulose	L2	1250	T	1/8 NPT Return
		1250	1 1/4"	10SYN	10 Micron Synthetic				
				25SYN	25 Micron Synthetic				

For indicator gauge specifications and ordering information see pages 38a-39a

**Indicators ordered and shipped separately*



Replacement Elements

Filter Number	Element Number	Media	in	cm	B-20/75/200	Dirt Holding
LFT-750, 1000	LFTE-1002-L1-10	10 Micron Cellulose	511	3300	6μ/8μ/13μ	15
	LFTE-1002-L1-25	25 Micron Cellulose	511	3300	25μ/35μ/43μ	20
	LFTE-1002-L1-10SYN	10 Micron Synthetic	372	2400	3μ/5.5μ/12μ	22
	LFTE-1002-L1-25SYN	25 Micron Synthetic	372	2400	7μ/16μ/23μ	26
LFT-1250	LFTE-1252-L2-10	10 Micron Cellulose	698	4500	6μ/8μ/13μ	21
	LFTE-1252-L2-25	25 Micron Cellulose	698	4500	25μ/35μ/43μ	28
	LFTE-1252-L2-10SYN	10 Micron Synthetic	504	3250	3μ/5.5μ/12μ	30
	LFTE-1252-L2-25SYN	25 Micron Synthetic	504	3250	7μ/16μ/23μ	35

Beta Rating of 2 = 50% Efficiency
Beta Rating of 20 = 95% Efficiency
Beta Rating of 75 = 98.7% Efficiency
Note: 45 PSI Pressure Drop Maximum



General Filter Specifications

Bypasses

Differential opening set value + - 10%

Medias

Cellulose	Resin impregnated paper
Synthetic	Inorganic micro fiber
Wire Mesh	140 micron, 100 mesh stainless Steel
Water Removal	10 micron resin impregnated paper

Compatibility of Fluids with

Filter Heads & Bowls Per ISO 6743/4

Mineral oils (types HH, HL, HM, HR, HV)
Water based emulsions (types HFAE, HFAS)
Synthetic fluids (types HS, HFDR, HFDS, HFFU)
Water glycol (types HFC)



LIT-1252-Bypass



LIT-1252-10P



CP-752-10

Compatibility of Fluids with Filter Elements Per ISO 2943

Mineral oils (types HH, HL, HM, HR, HV, HG) ISO 6743/4
Synthetic fluids (types A & M series only)
Water based emulsions consult Lenz for further information

Compatibility of Fluids with Seals Per ISO 6743/4

Nitrile (Buna N)

Mineral Oils (HH, HL, HM, HR, HV, HG)
Water emulsion (HFAE, HFAS)
Water glycol (HFC)

Viton seals

Synthetic fluids (types HS, HFDR, HFDS, HFDU)

Indicator Options

Visual	Suction & return visual gauges
Electrical	Suction & return electrical switches
Differential	Return indicators

Mineral Oil Types

HH	Non inhibited refined mineral oils
HL	Refined mineral oils with anti-oxidation and anti-rust properties
HM	HL fluids with improved anti wear
HR	HL oils with VI improvers
HV	Lubricants with high viscosity
HG	HM oils with anti-stick slip properties

Water Based Emulsion Types

HFAE	Oil water emulsions or aqueous fluids which are further with additional letters
HFAS	Solutions of chemicals containing minimum 80% of water
HFC	Aqueous solutions with viscosity-increasing additives and minimum 35% mass water

Synthetic Fluid Types

HFDU	Fire resistant fluids of other compositions
HFDS	HFD based upon phosphoric acid ester
HS	Synthetic fluids with no specific fire resistant properties
HFDR	HFD based on halogen-containing compounds





2" Diameter Filter Indicating Gauges



MC-12

Return Line Indicating Gauge
for 15 PSI Filter Applications
2" Multi color

0-12 PSI Green
12-15 PSI Yellow
15-60 PSI Red (Service Filter)
(To be used with "T" Indicator Port Location)



MC-20

Return Line Indicating Gauge
for 25 PSI Filter Applications
2" Multi color

0-20 PSI Green
21-24 PSI Yellow
25-60 PSI Red (Service Filter)
(To be used with "T" Indicator Port Location)



CHANGE FILTER

CP-2

Compound Indicating Gauge
(Suction or Return Line)

10" to 30" Vacuum is a Red Danger Area.
0-60 PSI
A Red "Change Filter" Sticker for the
Pressure side is included with each gauge
for application after the pressure factor
is determined.
(To be used with "T" or "S" Indicator Port Location)



GLY-MC-20

Glycerin Filled
Return Line Indicating Gauge
for 25 PSI Filter Applications
2" Multi color

0-20 PSI Green
21-24 PSI Yellow
25-60 PSI Red (Service Filter)
(To be used with "T" Indicator Port Location)



135080

Suction Line Indicating Gauge for
5 PSI vacuum filter application
2" Multi color

0-9" HG Green
9-11" HG Yellow
11-30" HG Red (Service Filter)
(To be used with "S" Indicator Port Location)

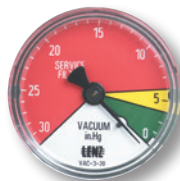

VAC-3-20

Suction Line Indicating Gauge
for 3 PSI vacuum filter applications
2" Multi color

0-3" HG Green
4-6" HG Yellow
6-30" HG Red (Service Filter)
(To be used with "S" Indicator Port Location)



Differential Indicator DP-75

Simple differential sliding
indicator which changes from
green to red at 7 PSID.

0 - 7 PSID. Green Clean
7 - 10 PSID. Red Service Filter
CP Series (500, 750, 1010, 1280,
1580)

*Indicators ordered and shipped separately

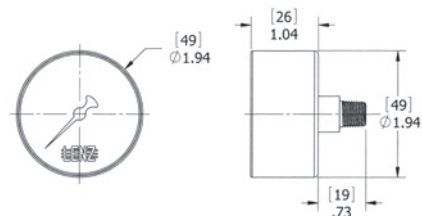

DIAL INDICATOR

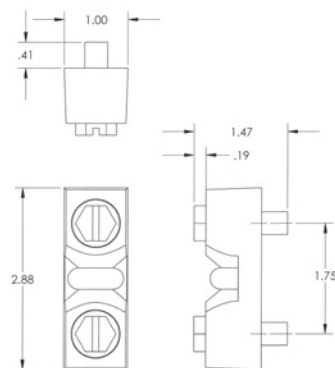

DP-75



Electrical Filter Indicators

Field Adjustable

Specifications:

- 1/8 NPT connection
- 3 AMP 12/24 VDC, 125/250 VAC IP67
- +/- 2% repeatability of full set point range @ 70°F
- Operating temperature 40°F to +250°F (-40°C to 121°C)
- 1,000,000 cycles mechanical range
- Maximum pressure 500 (25 BAR) PSI
- Steel housing, zinc plated
- Buna N diaphragm
- SPDT snap action switch

Options:

- EPDM seals -10°F – 250°F (-23°C – 121°C)
- Viton seals 0 – 250°F (-18°C – 121°C)
- Flying leads



LES-FL



LES-HC

Model	Adjustment Range	Average Differential	Set Pressure
P1	3-20 PSI (.2-1.4 BAR)	2-5 PSI (.13-0.4 BAR)	15 PSI
P2	15-80 PSI (1.03-6 BAR)	4-7 PSI (.27-0.5 BAR)	22 PSI
V1	5-28 in Hg (160-948mb)	2-4 INHg (67-135mb)	5 Hg

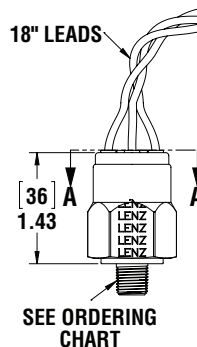
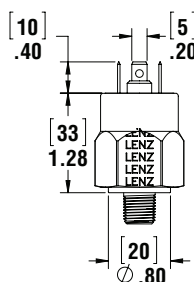
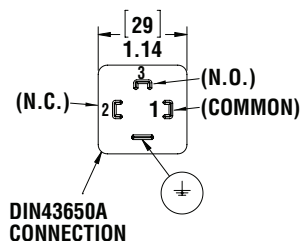
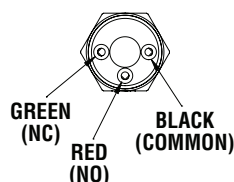
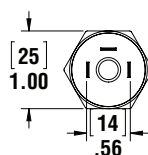

SEE ORDERING CHART

LES-FL

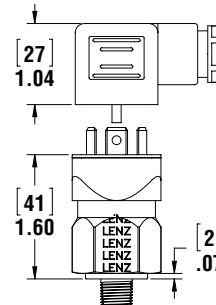

LES-HC

Switch Ordering Code

LES – P1 – 2N – B – HC –

Series	Adjustment Range	Thread	Seals	Electrical Connection	Options
LES	P1 3-20 PSI P2 15-80 PSI V1 5-30" HG Rising	2N 1/8" NPT 4N 1/4" NPT 4S 7/16"-20 6S 9/16"-18	B Buna V Viton E EPDM	FL Flying Leads HC Din Clamp	Omit SS Stainless Housing IL Ind Light

**Indicators ordered and shipped separately*

Switch can be used in AC or DC Service.
For other options consult factory.
Switch does not indicate differential pressure

See Technical Bulletin TB.FIL23.912, or further information at
(Technical Data – www.lenzinc.com)