



Steel Sight Windows

Model SSW-A, SWA-A

Specifications

- Machined from steel zinc plated (SSW-A)
- Maximum working pressure 20 PSI
- 9/16"-18 to 2 1/2"-12 SAE threads available
- Viton seals standard 250°F (120°C)
- Tempered glass lens
- Compatible with most hydraulic fluids & lubricating oils
avoid contact with alcohol or solvents
- Recommended tightening torque 5 ft/lbs
- Steel zinc plated reflector

Options

- Buna seals 176°F (80°C)
- Aluminum hex bushing (SWA-A)



SWA-A



SSW-A

Dimensional Detail

Model	A Port Thread		B	F
SSW-A6	9/16"-18	in.	0.39	1.00
		mm	10	25
SSW-A8	3/4"-16	in.	0.55	1.00
		mm	14	25
SSW-A12	1 1/16"-12	in.	0.79	1.26
		mm	20	32
SSW-A16	1 5/16"-12	in.	0.88	1.90
		mm	24	38
SSW-A20	1 5/8"-12	in.	1.30	1.97
		mm	33	50
SSW-A24	1 7/8"-12	in.	1.54	2.17
		mm	39	55

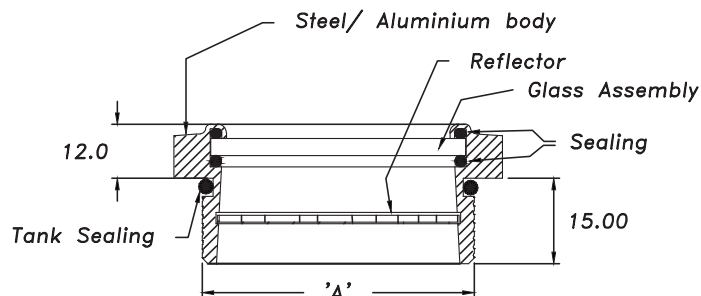
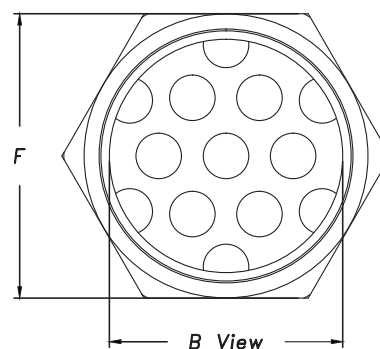

Ordering Code

SSW - A12 - R - B

Series		Port Size		Options		Seals	
SSW	SAE	A6		Omit	W/O Reflector	Omit	Viton
*SWA	SAE	A8		R	Reflector	B	Buna
*Consult Lenz		A12		* "R" option is currently stocked.			
		A16					
		A20					
		A24					