



Oil Level Indicators

LSG, LSGR

- Transparent Polymide Material / Not compatible with Alcohol
- Maximum Operating Temperature 212°F (100°C) / Nitrile Seal
- Compatible with Petroleum Based Fluids, Gasoline, Fuel, and variety of Solvents
- NPT, BSP and SAE Threads available
- Maximum Pressure 44 PSI (3 Bar)
- Central Red indicator Point
- Contrast reflector available
- Locknut available for mounting on reservoirs less than .2 inches wall thickness



LSG-A-R
(SAE)



LSG-R
(NPT/BSP)

Dimensional Detail

BSPP		Ch	F	D	d	h1	h2	TORQUE	
LSG-4	in.	0.7	G 1/4	0.8	0.5	0.3	0.3	1.5-2	ft. lbs.
	mm	17		20.5	12	8	8.5	2-3	nm
LSG-6	in.	0.7	G 3/8	0.9	0.5	0.3	0.5	2-3.5	ft. lbs.
	mm	18		22	12	6.5	12	3-5	nm
LSG-8	in.	0.9	G 1/2	1.1	0.6	0.3	0.5	3-4.5	ft. lbs.
	mm	24		28	16	8	12	4-6	nm
LSG-12	in.	1.2	G 3/4	1.4	0.8	0.3	0.5	4.5-6	ft. lbs.
	mm	30		36	21	8.5	13.5	6-8	nm
LSG-16	in.	1.4	G 1	1.7	1.2	0.4	0.6	6-7.5	ft. lbs.
	mm	36		42	30	9	14	8-10	nm
LSG-20	in.	1.7	G 1 1/4	2.0	1.3	0.4	0.7	6-7.5	ft. lbs.
	mm	42		51	32	10	17	8-10	nm
LSG-24	in.	2.0	G 1 1/2	2.3	1.5	0.4	0.8	9-11	ft. lbs.
	mm	50		58	39	10	21	12-15	nm
LSG-32	in.	2.5	G 2	2.9	1.9	0.5	0.8	9-11	ft. lbs.
	mm	64		74	48	12	20	12-15	nm
NPT									
LSG-12	in.	0.9	3/4	1.1	0.9	0.2	0.7		ft. lbs.
	mm	24		28	23	6	19		nm
LSG-16	in.	1.2	1	1.4	1.1	0.4	0.8		ft. lbs.
	mm	30		36	27	10	21		nm
LSG-20	in.	1.4	1 1/4	1.7	1.3	0.4	0.9		ft. lbs.
	mm	36		42	32	10.7	22.9		nm
SAE									
LSG-A8	in.	1.1	3/4"-16	0.6	0.7	0.3	0.5	1.5-2	ft. lbs.
	mm	28		16	18	8	12	2-3	nm
LSG-A12	in.	0.9	11/16"-12	1.4	0.9	0.4	0.6	1.5-2	ft. lbs.
	mm	24		36	23	9	16	2-3	nm
LSG-A16	in.	1.2	15/16"-12	1.7	1.1	0.4	0.7		ft. lbs.
	mm	30		43	29	10	18		nm
LSG-A24V	in.	2.0	17/8"-12	2.3	1.7	0.4	0.8		ft. lbs.
	mm	51		58	43	10	21		nm
Metric									
LSG-14.15	in.	0.7	M14 X 1.5	0.8	0.5	0.3	0.3	1.5-2	ft. lbs.
	mm	17		20	12	7.5	8	2-3	nm
LSG-1615	in.	0.7	M16 X 1.5	0.9	0.5	0.3	0.5	1.5-2	ft. lbs.
	mm	18		22	12	6.5	12.5	2-3	nm
LSG1815	in.	0.8	M18 X 1.5	1.0	0.6	0.2	0.5	6-7.5	ft. lbs.
	mm	21		25.5	14	6	12.5	8-10	nm
LSG-2015	in.	0.9	M20 X 1.5	1.1	0.6	0.3	0.5	6-7.5	ft. lbs.
	mm	24		28	16	7.5	12	8-10	nm
LSG-2215	in.	0.9	M22 X 1.5	1.1	0.6	0.3	0.5	6-7.5	ft. lbs.
	mm	24		28	16	7.5	12.5	8-10	nm
LSG-2615	in.	1.2	M26 X 1.5	1.4	0.8	0.3	0.5	6-7.5	ft. lbs.
	mm	30		36	21	8.5	13.5	8-10	nm
LSG-2715	in.	1.2	M27 X 1.5	1.4	0.8	0.3	0.5	6-7.5	ft. lbs.
	mm	30		36	21	8.5	13.5	8-10	nm
LSG-4015	in.	1.7	M40 X 1.5	2.0	1.3	0.4	0.7	6-7.5	ft. lbs.
	mm	42		51	32	10	17	8-10	nm

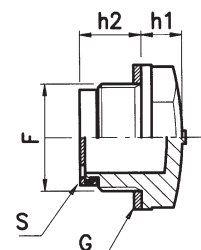
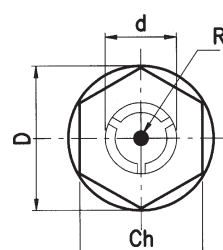

G = Fiber gasket (BSPP only) FASIT 202



WFA Weld Flange



LWBA Weld Flange

For SAE & NPT Weld Port Flanges and
Adapters see page 53a-54a